

**Style S099** 1:4 Scale

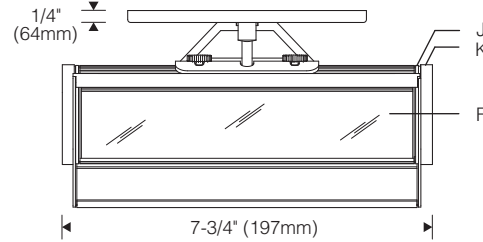

**Pendant and Cantilever**

1:12 Scale

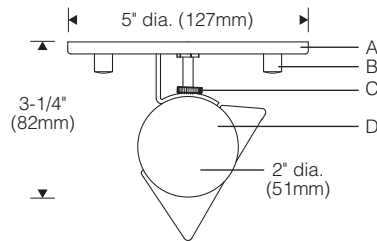
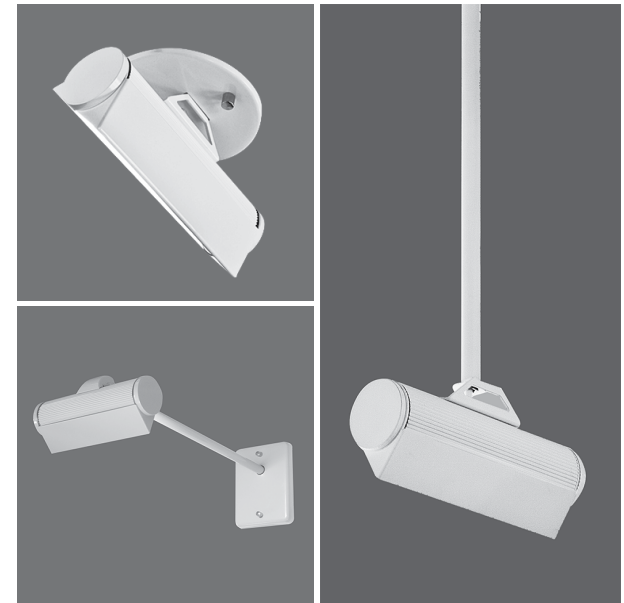
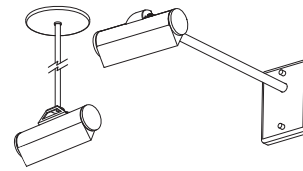

**Optical Assembly** 1:2 Scale

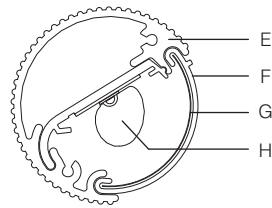

**Visor Options** 1:6 Scale

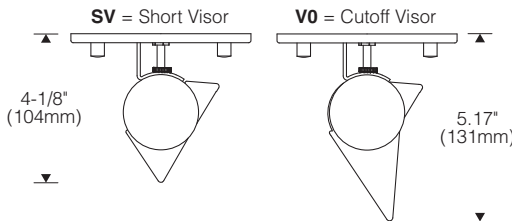

**Remote Driver**

See remote LED driver document [MA-1357](#) for dimensions and wiring, mounting instructions.

**Specifications**

- |   |  |   |   |
|---|--|---|---|
| <b>A</b> Aluminum canopy                                    | <b>D</b> Optical assembly                    | <b>G</b> Holographic diffuser   | <b>K</b> Aluminum decorative end plate                  |
| <b>B</b> Chrome cap nuts                                    | <b>E</b> Extruded aluminum heat sink/housing | <b>H</b> Field serviceable light engine with <b>fraqtir™</b> asymmetric optic | <b>L</b> Remote constant current LED driver, indoor use |
| <b>C</b> Aluminum adjustment bracket with brass thumbscrews | <b>F</b> Impact-resistant extruded lens      | <b>J</b> Aluminum reveal plate  |   |

**Features**

- **fraqtir** technology – precise asymmetric optical control
- Wide distribution – great vertical and lateral uniformity
- Adjustable and lockable aiming
- Serviceability – removable light engine



**Optic Assembly:**

Two-piece extruded aluminum heat sink/optic housing. Exterior heat sink anodized for maximum emissivity. Removable interior extrusion treated to maximize thermal conductivity. Precision formed asymmetric optical light bar of high temperature, water-clear acrylic. Extruded impact resistant, high temperature, acrylic outer protective lens. Elliptical distribution holographic diffuser captured within outer protective lens, maximizes lateral distribution without disturbing asymmetric forward throw.

**Finish:**

Extruded aluminum heat sink/housing bright anodize, white or black finish. Formed aluminum canopy, adjustable back bracket, end plates finished white or black.

Painted surfaces – 6 stage pretreatment and electrostatically applied thermoset powder coat for stable, long lasting and corrosion resistant finish.

All hardware – stainless steel or nickel plated brass.

**Mounting:**

Cross bar mounts over recessed outlet box (by others) or directly to ceiling. Canopy mounts to cross bar via chrome cap nuts. Pendant or cantilever ordered separately; specify **X** mount.

Pendant stem – 11/16" O.D. aluminum, internally threaded. 5" dia. x 1/2" aluminum canopy.

Cantilever – 1" x 2" steel arm. Interface plate (under canopy) allows ±5° leveling.

**Electrical:**

Units are furnished with 5 foot (1.5m) leads for connection to remote driver Class II output. Remote electronic HPF thermally protected Class II driver mounted in aluminum enclosure. For complete driver specifications, see website, reference document MA-1303.

Optional electronic dimming driver; compatible dimming controls (by others). See website for dimming compatibility and specifications.

**Standard:**

UL listed and CSA certified for dry locations. 5 year warranty, maximum ambient temperature 45°C (113°F).

**Performance**

**fraqtir** technology uses a combination of refraction and total internal reflection, creating a distribution of light ideal for illuminating surfaces uniformly. Glare is minimized while light delivered to the target is maximized, resulting in high efficiency.

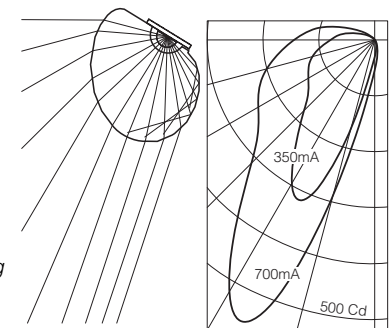

L90(10k) > 60,000 hrs @ 25°C per TM-21

For photometric and lumen maintenance reports, visit [thelightingquotient.com](http://thelightingquotient.com)



